

SECTION F



ADAPTOR MANIFOLD FOR SD02 STACKABLE SOLENOID VALVES



Dimensions in mm (inches)

PPC TO SD02 STACKABLE VALVE CONVERTER
(needed to mount SD02 stackable valves)

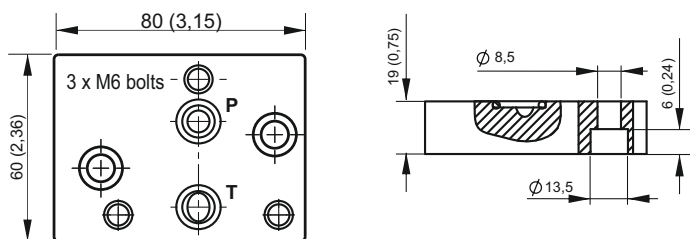

Fixing system: 2 M8x20 bolts steel class 8.8 or above
Weight: 0,22 Kg

Spare part code

E60403006DN



Dimensions in mm (inches)

PPM TO SD02 STACKABLE VALVE CONVERTER
(necessary to mount SD02 stackable valves)

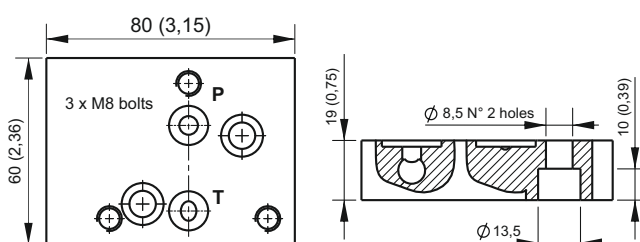

Fixing system: 2 M8x20 bolts steel class 8.8 or above
Weight: 0,22 Kg

Spare part code

N50403007DN